

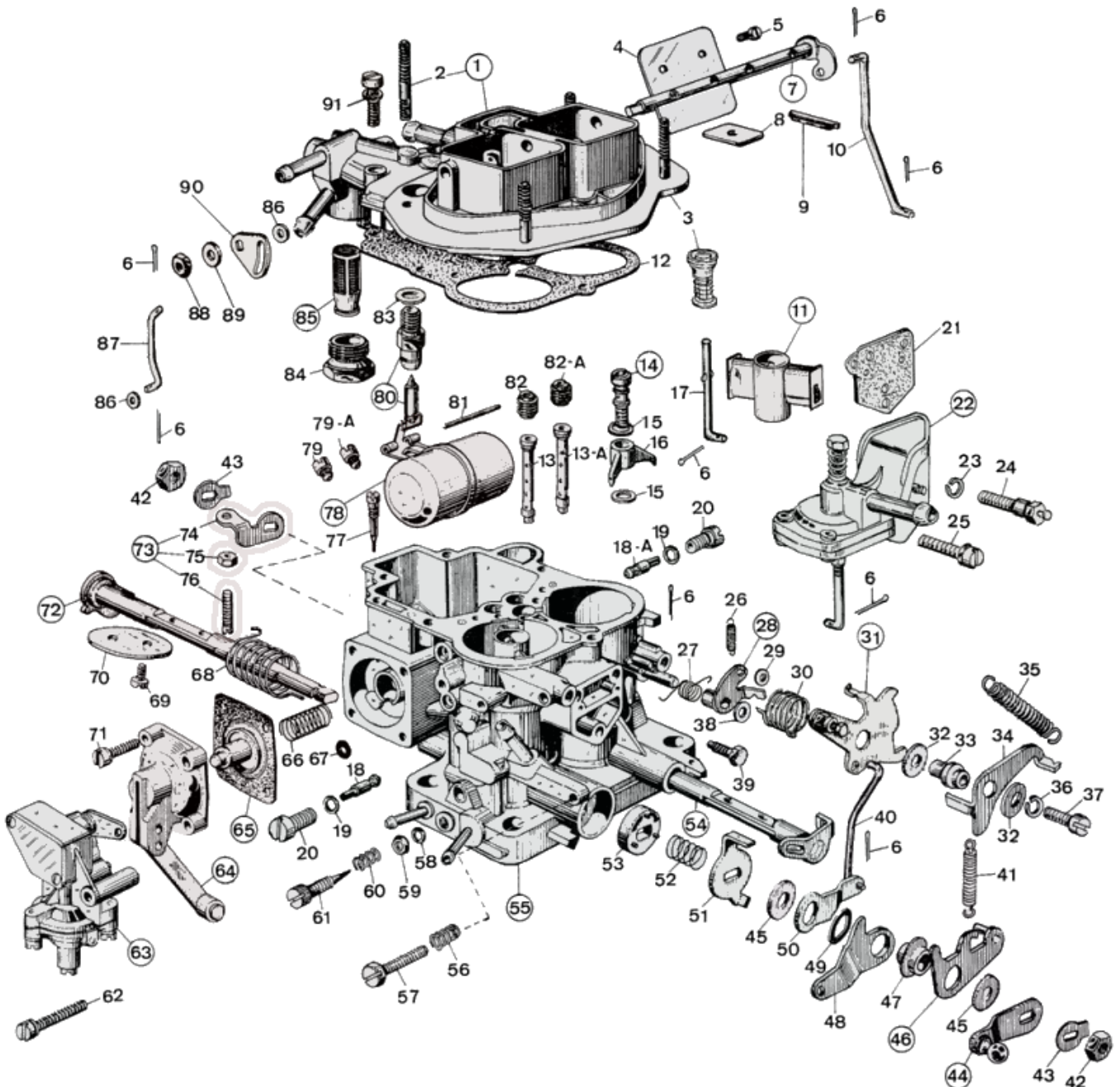

WEBER 32 DMSA - exploded view



<https://www.carbparts.eu>

Prices and product availability are subject to change



CarbDeal
Selling carburetor parts since 2005



WEBER 32 DMSA - Parts list

No	Part No	Price	Pcs	Description	No	Part No	Price	Pcs	Description
1	31716.209	\$ 0	1	Carburetor cover Assy, including:	48	45332.147	\$ 0	1	Leva allentata comando ammortizzatore
2	64955.007	\$ 13.9	4	Inspection cover stud	49	55530.002	\$ 3.6	1	Wavy Washer
3	64372.009	\$ 0	1	— Valvola sfiato	50	45067.014	\$ 12.2	1	Lever
4	64010.006	\$ 12.9	2	Choke throttle valve	51	45133.027	\$ 0	1	Lever
5	64525.003	\$ 0	4	Choke plate fixing screw	52	47600.027	\$ 0	1	Bush retaining spring
6	32610.005	\$ 1.7	8	Spilt pin	53	50002.005	\$ 9.1	1	Shaft Bushing
7	10020.213	\$ 0	1	Choke shaft	54	10015.507	\$ 0	1	Secondary Throttle Shaft
8	52135.010	\$ 3.5	2	Dust seal plate	54	10016.483	\$ 0	1	Secondary Throttle Shaft Oversized
9	61070.002	\$ 3.5	2	Dust seal plug	55		\$ 0	1	Carburettor body
10	61280.026	\$ 20.8	1	Choke Control Rod	56	47600.007	\$ 2.6	1	Idle Mixture Screw Spring
11	31966.015	\$ 0	2	Auxiliary venturi	57	64625.007	\$ 0.1	1	Throttle Adjustment Screw
12	41705.028	\$ 0	1	Top Cover Gasket	58	41565.002	\$ 0.5	1	Idle Mixture Screw 'O' Ring
13-A	61440.321	\$ 34.5	1	Primary Emulsion Tube	59	53000.006	\$ 0	1	Scodellino per vite registro minimo
13	61440.321	\$ 34.5	1	Primary Emulsion Tube	60	47600.007	\$ 2.6	1	Idle Mixture Screw Spring
14	64290.015	\$ 0	1	Valve	61	64750.003	\$ 3	1	Idle mixture screw
15	41530.012	\$ 0	2	Pump jet gasket	62	64700.008	\$ 6.7	2	Fixing Screw
16	41252.012	\$ 11	1	Pump jet	63	57804.032	\$ 0	1	Dispositivo di sgolfamento
17	61280.036	\$ 0	1	Tie rod	64	32486.019	\$ 0	1	Accelerator Pump Cover
18	41160.003	\$ 3	1	Idle jet	65	47407.100	\$ 0	1	Pump diaphragm
18-A	41160.003	\$ 3	1	Idle jet	66	47600.092	\$ 0	1	Pump Spring
19	41565.002	\$ 0.5	2	O-Ring For Idle Jet Holder	67	41565.008	\$ 0.9	1	O ring
20	52570.006	\$ 7.4	2	Idle Jet Holder	68	47610.024	\$ 0	1	Primary Shaft Return Spring
21	41640.018	\$ 2.8	1	Guarnizione per capsula	69	64520.023	\$ 3.3	4	Throttle Plate Screw
22	31800.025	\$ 0	1	Capsula	70	64005.090	\$ 18.4	2	Throttle Valve
23	55525.001	\$ 0	1	Spring Washer	71	64700.006	\$ 0	4	Pump Cover Screw
24	52025.010	\$ 0	1	Perno fissaggio capsula e molla	72	10016.459	\$ 0	1	Secondary Shaft Oversized
25	64700.011	\$ 0	1	Fixing Screw	72	10015.470	\$ 0	1	Primary Throttle Shaft
26	47605.006	\$ 0	1	Spindle return spring	73	45034.054	\$ 0	1	Pump Lever
27	47610.026	\$ 0	1	Spring	74	45032.114	\$ 0	1	— Throttle Lever
28	45034.048	\$ 0	1	Choke Lever	75	34705.001	\$ 0.9	1	Nut
29	55510.056	\$ 1.7	1	Flat Washer	76	64595.007	\$ 0	1	— Screw
30	47610.056	\$ 5.9	1	Spring	77	64900.001	\$ 9	1	Pump discharge blanking needle
31	45202.044	\$ 0	1	Lever	78	41015.004	\$ 61.9	1	Float
32	55510.002	\$ 1.7	2	Spring Washer	79	41120.001	\$ 3.2	1	Main jet
33	12775.061	\$ 0	1	Bushing	79A	41120.001	\$ 3.2	1	Main jet
34	45200.058	\$ 0	1	Leva comando secondo stadio avviam	80	64240.008	\$ 0	1	Float valve
35	47605.009	\$ 1.9	1	Throttle Return Spring	81	52000.015	\$ 2.1	1	Float pivot
36	55525.001	\$ 0	1	Spring Washer	82-A	41360.001	\$ 2.6	1	Air bleed jet
37	64520.002	\$ 0	1	Fixing Screw	82	41360.001	\$ 2.6	1	Air bleed jet
38	55510.034	\$ 0.5	1	Spring Washer	83	41535.015	\$ 0	1	Needle valve gasket
39	64605.017	\$ 2.1	1	Choke Cable Clamp	84	61002.018	\$ 9	1	Fuel Filter Cover
40	61280.061	\$ 0	1	Tie rod	85	37022.002	\$ 4.4	1	Filter element
41	47605.010	\$ 5.9	1	Spindle return spring	86	55510.019	\$ 1.4	2	Spring Washer
42	34710.003	\$ 1.2	2	Throttle Spindle Nut	87	61280.060	\$ 0	1	Choke Control Rod
43	55520.004	\$ 1.2	2	Throttle Shaft Lock Washer	88	34715.006	\$ 0	1	— Cold Start Nut
44	45027.092	\$ 0	1	Throttles control lever	89	55530.008	\$ 4.3	1	Spring Ring
45	55510.015	\$ 0	2	Spacer	90	45129.009	\$ 0	1	Lever
46	45069.006	\$ 31	1	Lever	91	64700.005	\$ 0.6	5	Top Cover Fixing Screw
47	12775.039	\$ 0	1	Spacer Bushing					

<https://www.carbparts.eu>

Prices and product availability are subject to change

