

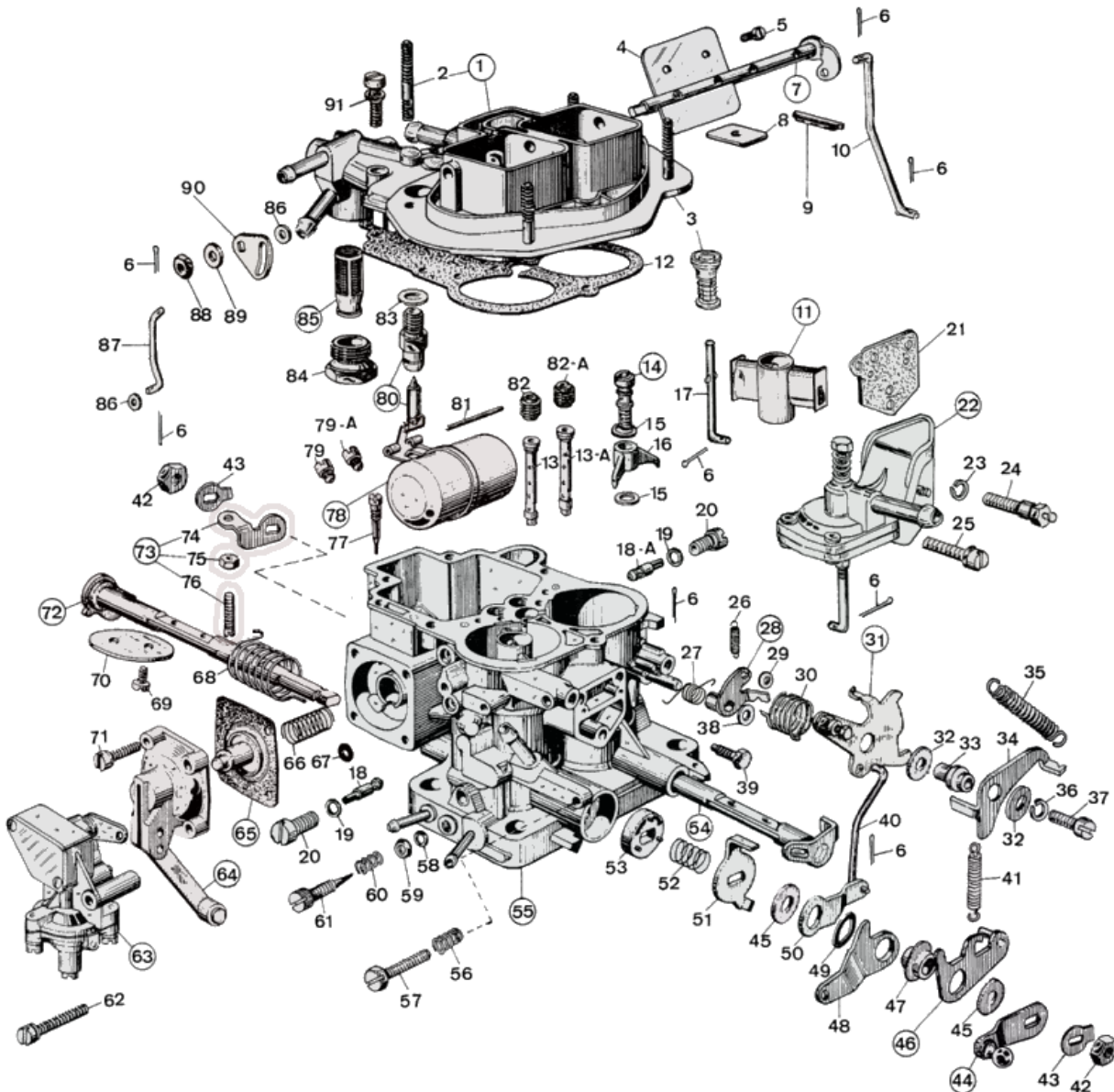

# WEBER 32 DMSA

*Exploded view*



<https://www.carbparts.eu>

Prices and product availability are subject to change



# WEBER 32 DMSA

## List of parts



No	Part No	Price	Pcs	Description
1	31716.209	\$ 0	1	Carburetor cover Assy, including:
2	64955.007	\$ 12.8	4	Inspection cover stud
3	64372.009	\$ 0	1	— Valvola sfiato
4	64010.006	\$ 11.9	2	Choke throttle valve
5	64525.003	\$ 0	4	Choke plate fixing screw
6	32610.005	\$ 1.5	8	Spilt pin
7	10020.213	\$ 0	1	Choke shaft
8	52135.010	\$ 3.3	2	Dust seal plate
9	61070.002	\$ 3.3	2	Dust seal plug
10	61280.026	\$ 19.1	1	Choke Control Rod
11	31966.015	\$ 0	2	Auxiliary venturi
12	41705.028	\$ 0	1	Top Cover Gasket
13-A	61440.321	\$ 15.7	1	Primary Emulsion Tube
13	61440.321	\$ 15.7	1	Primary Emulsion Tube
14	64290.015	\$ 0	1	Valve
15	41530.012	\$ 0	2	Pump jet gasket
16	41252.012	\$ 12.4	1	Pump jet
17	61280.036	\$ 0	1	Tie rod
18-A	41160.003	\$ 3.3	1	Idle jet
18	41160.003	\$ 3.3	1	Idle jet
19	41565.002	\$ 0.4	2	O-Ring For Idle Jet Holder
20	52570.006	\$ 7	2	Idle Jet Holder
21	41640.018	\$ 2.5	1	Guarnizione per capsula
22	31800.025	\$ 0	1	Capsula
23	55525.001	\$ 0	1	Spring Washer
24	52025.010	\$ 0	1	Perno fissaggio capsula e molla
25	64700.011	\$ 0	1	Fixing Screw
26	47605.006	\$ 0	1	Spindle return spring
27	47610.026	\$ 0	1	Spring
28	45034.048	\$ 0	1	Choke Lever
29	55510.056	\$ 1.6	1	Flat Washer
30	47610.056	\$ 5.4	1	Spring
31	45202.044	\$ 0	1	Lever
32	55510.002	\$ 1.6	2	Spring Washer
33	12775.061	\$ 0	1	Bushing
34	45200.058	\$ 0	1	Leva comando secondo stadio avviam
35	47605.009	\$ 2.5	1	Throttle Return Spring
36	55525.001	\$ 0	1	Spring Washer
37	64520.002	\$ 0	1	Fixing Screw
38	55510.034	\$ 0.4	1	Spring Washer
39	64605.017	\$ 2	1	Choke Cable Clamp
40	61280.061	\$ 0	1	Tie rod
41	47605.010	\$ 5.2	1	Spindle return spring
42	34710.003	\$ 1.1	2	Throttle Spindle Nut
43	55520.004	\$ 1.1	2	Throttle Shaft Lock Washer
44	45027.092	\$ 0	1	Throttles control lever
45	55510.015	\$ 0	2	Spacer
46	45069.006	\$ 28.6	1	Lever
47	12775.039	\$ 0	1	Spacer Bushing

No	Part No	Price	Pcs	Description
48	45332.147	\$ 0	1	Leva allentata comando ammortizzatore
49	55530.002	\$ 3.3	1	Wavy Washer
50	45067.014	\$ 11.2	1	Lever
51	45133.027	\$ 0	1	Lever
52	47600.027	\$ 5.2	1	Bush retaining spring
53	50002.005	\$ 8.4	1	Shaft Bushing
54	10015.507	\$ 0	1	Secondary Throttle Shaft
54	10016.483	\$ 0	1	Secondary Throttle Shaft Oversized
55		\$ 0	1	Carburetor body
56	47600.007	\$ 2.5	1	Idle Mixture Screw Spring
57	64625.007	\$ 0.1	1	Throttle Adjustment Screw
58	41565.002	\$ 0.4	1	Idle Mixture Screw 'O' Ring
59	53000.006	\$ 0	1	Scodellino per vite registro minimo
60	47600.007	\$ 2.5	1	Idle Mixture Screw Spring
61	64750.003	\$ 4	1	Idle mixture screw
62	64700.008	\$ 6.1	2	Fixing Screw
63	57804.032	\$ 0	1	Dispositivo di sgolfamento
64	32486.019	\$ 0	1	Accelerator Pump Cover
65	47407.100	\$ 0	1	Pump diaphragm
66	47600.092	\$ 0	1	Pump Spring
67	41565.008	\$ 0.9	1	O ring
68	47610.024	\$ 0	1	Primary Shaft Return Spring
69	64520.023	\$ 0.7	4	Throttle Plate Screw
70	64005.090	\$ 17.4	2	Throttle Valve
71	64700.006	\$ 0	4	Pump Cover Screw
72	10016.459	\$ 0	1	Secondary Shaft Oversized
72	10015.470	\$ 0	1	Primary Throttle Shaft
73	45034.054	\$ 0	1	Pump Lever
74	45032.114	\$ 0	1	— Throttle Lever
75	34705.001	\$ 0.8	1	Nut
76	64595.007	\$ 0	1	— Screw
77	64900.001	\$ 11.9	1	Pump discharge blanking needle
78	41015.004	\$ 57	1	Float
79A	41120.001	\$ 4.1	1	Main jet
79	41120.001	\$ 4.1	1	Main jet
80	64240.008	\$ 0	1	Float valve
81	52000.015	\$ 2	1	Float pivot
82-A	41360.001	\$ 3.3	1	Air bleed jet
82	41360.001	\$ 3.3	1	Air bleed jet
83	41535.015	\$ 0.3	1	Needle valve gasket
84	61002.018	\$ 11.9	1	Fuel Filter Cover
85	37022.002	\$ 5.8	1	Filter element
86	55510.019	\$ 1.3	2	Spring Washer
87	61280.060	\$ 0	1	Choke Control Rod
88	34715.006	\$ 0	1	— Cold Start Nut
89	55530.008	\$ 4	1	Spring Ring
90	45129.009	\$ 0	1	Lever
91	64700.005	\$ 0.6	5	Top Cover Fixing Screw

<https://www.carbparts.eu>

Prices and product availability are subject to change