

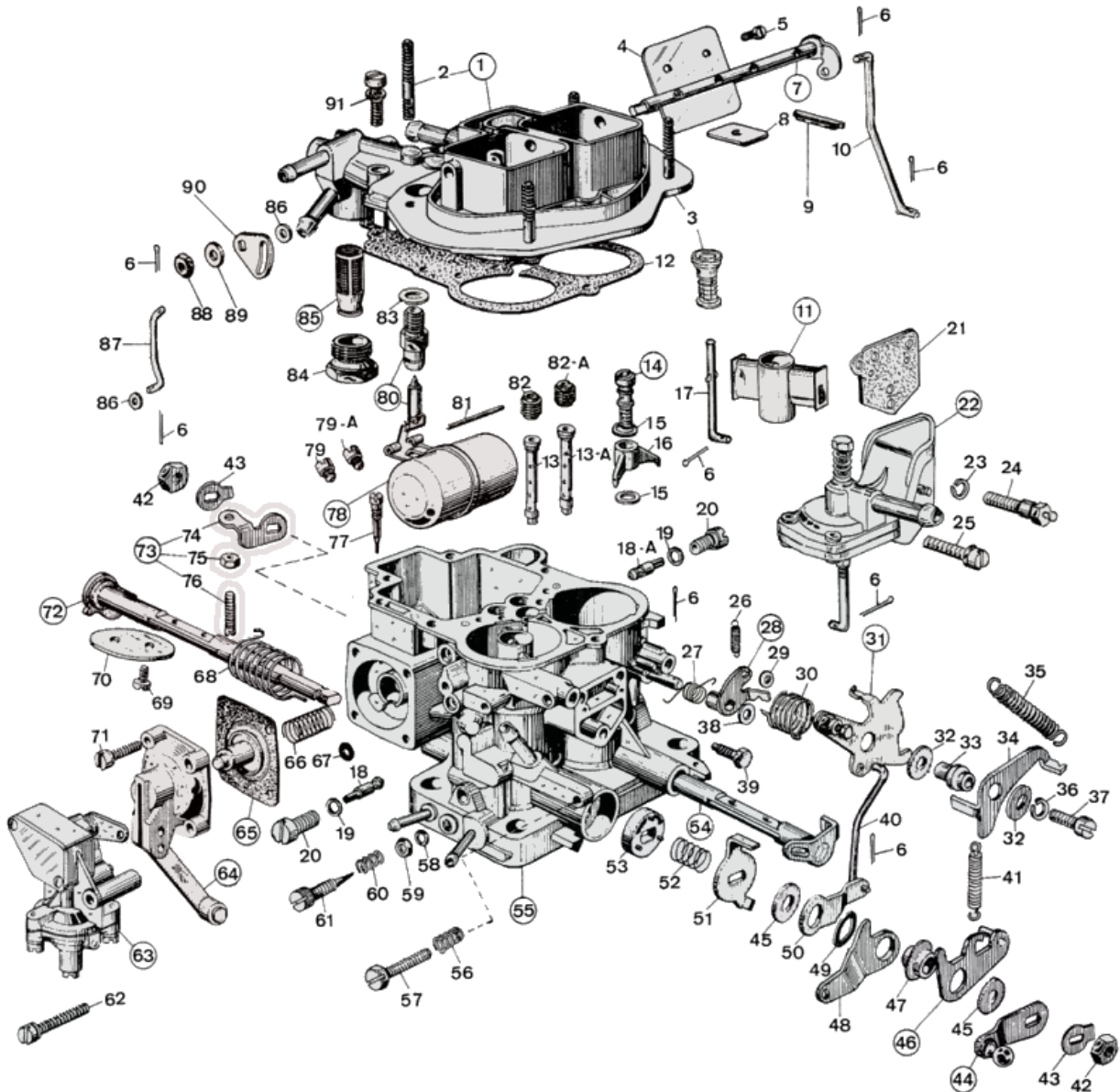

WEBER 32 DMSA

Exploded view



<https://www.carbparts.eu>

Los precios y la disponibilidad de los productos están sujetos a cambios



WEBER 32 DMSA

Lista de partes



No	Parte No	Precio	Pcs	Descripción
1	31716.209	-	1	Carburetor cover Assy, including:
2	64955.007	\$ 13.5	4	Inspection cover stud
3	64372.009	-	1	— Valvola sfiato
4	64010.006	\$ 12.5	2	Choke throttle valve
5	64525.003	-	4	Choke plate fixing screw
6	32610.005	\$ 1.6	8	Spilt pin
7	10020.213	-	1	Choke shaft
8	52135.010	\$ 3.4	2	Dust seal plate
9	61070.002	\$ 3.4	2	Dust seal plug
10	61280.026	\$ 20.2	1	Choke Control Rod
11	31966.015	-	2	Auxiliary venturi
12	41705.028	-	1	Top Cover Gasket
13-A	61440.321	\$ 16.3	1	Primary Emulsion Tube
13	61440.321	\$ 16.3	1	Primary Emulsion Tube
14	64290.015	-	1	Valve
15	41530.012	-	2	Pump jet gasket
16	41252.012	\$ 12.8	1	Pump jet
17	61280.036	-	1	Tie rod
18-A	41160.003	\$ 3.4	1	Idle jet
18	41160.003	\$ 3.4	1	Idle jet
19	41565.002	-	2	O-Ring For Idle Jet Holder
20	52570.006	\$ 7.3	2	Idle Jet Holder
21	41640.018	\$ 2.7	1	Guarnizione per capsula
22	31800.025	-	1	Capsula
23	55525.001	-	1	Spring Washer
24	52025.010	-	1	Perno fissaggio capsula e molla
25	64700.011	-	1	Fixing Screw
26	47605.006	-	1	Spindle return spring
27	47610.026	-	1	Spring
28	45034.048	-	1	Choke Lever
29	55510.056	\$ 1.7	1	Flat Washer
30	47610.056	\$ 5.7	1	Spring
31	45202.044	-	1	Lever
32	55510.002	\$ 1.7	2	Spring Washer
33	12775.061	-	1	Bushing
34	45200.058	-	1	Leva comando secondo stadio avviam
35	47605.009	\$ 2.4	1	Throttle Return Spring
36	55525.001	-	1	Spring Washer
37	64520.002	-	1	Fixing Screw
38	55510.034	-	1	Spring Washer
39	64605.017	\$ 1.7	1	Choke Cable Clamp
40	61280.061	-	1	Tie rod
41	47605.010	\$ 4.9	1	Spindle return spring
42	34710.003	\$ 1.1	2	Throttle Spindle Nut
43	55520.004	\$ 1.1	2	Throttle Shaft Lock Washer
44	45027.092	-	1	Throttles control lever
45	55510.015	-	2	Spacer
46	45069.006	\$ 30.2	1	Lever
47	12775.039	-	1	Spacer Bushing

No	Parte No	Precio	Pcs	Descripción
48	45332.147	-	1	Leva allentata comando ammortizzatore
49	55530.002	\$ 3.5	1	Wavy Washer
50	45067.014	\$ 11.9	1	Lever
51	45133.027	-	1	Lever
52	47600.027	\$ 4.9	1	Bush retaining spring
53	50002.005	\$ 8.9	1	Shaft Bushing
54	10015.507	-	1	Secondary Throttle Shaft
54	10016.483	-	1	Secondary Throttle Shaft Oversized
55	-	-	1	Carburettor body
56	47600.007	\$ 2.6	1	Idle Mixture Screw Spring
57	64625.007	-	1	Throttle Adjustment Screw
58	41565.002	-	1	Idle Mixture Screw 'O' Ring
59	53000.006	-	1	Scodellino per vite registro minimo
60	47600.007	\$ 2.6	1	Idle Mixture Screw Spring
61	64750.003	\$ 3.8	1	Idle mixture screw
62	64700.008	\$ 6.5	2	Fixing Screw
63	57804.032	-	1	Dispositivo di sgolfamento
64	32486.019	-	1	Accelerator Pump Cover
65	47407.100	-	1	Pump diaphragm
66	47600.092	-	1	Pump Spring
67	41565.008	-	1	O ring
68	47610.024	-	1	Primary Shaft Return Spring
69	64520.023	-	4	Throttle Plate Screw
70	64005.090	\$ 18.1	2	Throttle Valve
71	64700.006	-	4	Pump Cover Screw
72	10016.459	-	1	Secondary Shaft Oversized
72	10015.470	-	1	Primary Throttle Shaft
73	45034.054	-	1	Pump Lever
74	45032.114	-	1	— Throttle Lever
75	34705.001	-	1	Nut
76	64595.007	-	1	— Screw
77	64900.001	\$ 11.3	1	Pump discharge blanking needle
78	41015.004	\$ 60.2	1	Float
79A	41120.001	\$ 4.3	1	Main jet
79	41120.001	\$ 4.3	1	Main jet
80	64240.008	-	1	Float valve
81	52000.015	\$ 2.1	1	Float pivot
82-A	41360.001	\$ 3.4	1	Air bleed jet
82	41360.001	\$ 3.4	1	Air bleed jet
83	41535.015	-	1	Needle valve gasket
84	61002.018	\$ 11.3	1	Fuel Filter Cover
85	37022.002	\$ 5.5	1	Filter element
86	55510.019	\$ 1.4	2	Spring Washer
87	61280.060	-	1	Choke Control Rod
88	34715.006	-	1	— Cold Start Nut
89	55530.008	\$ 4.2	1	Spring Ring
90	45129.009	-	1	Lever
91	64700.005	-	5	Top Cover Fixing Screw

<https://www.carbparts.eu>

Los precios y la disponibilidad de los productos están sujetos a cambios