

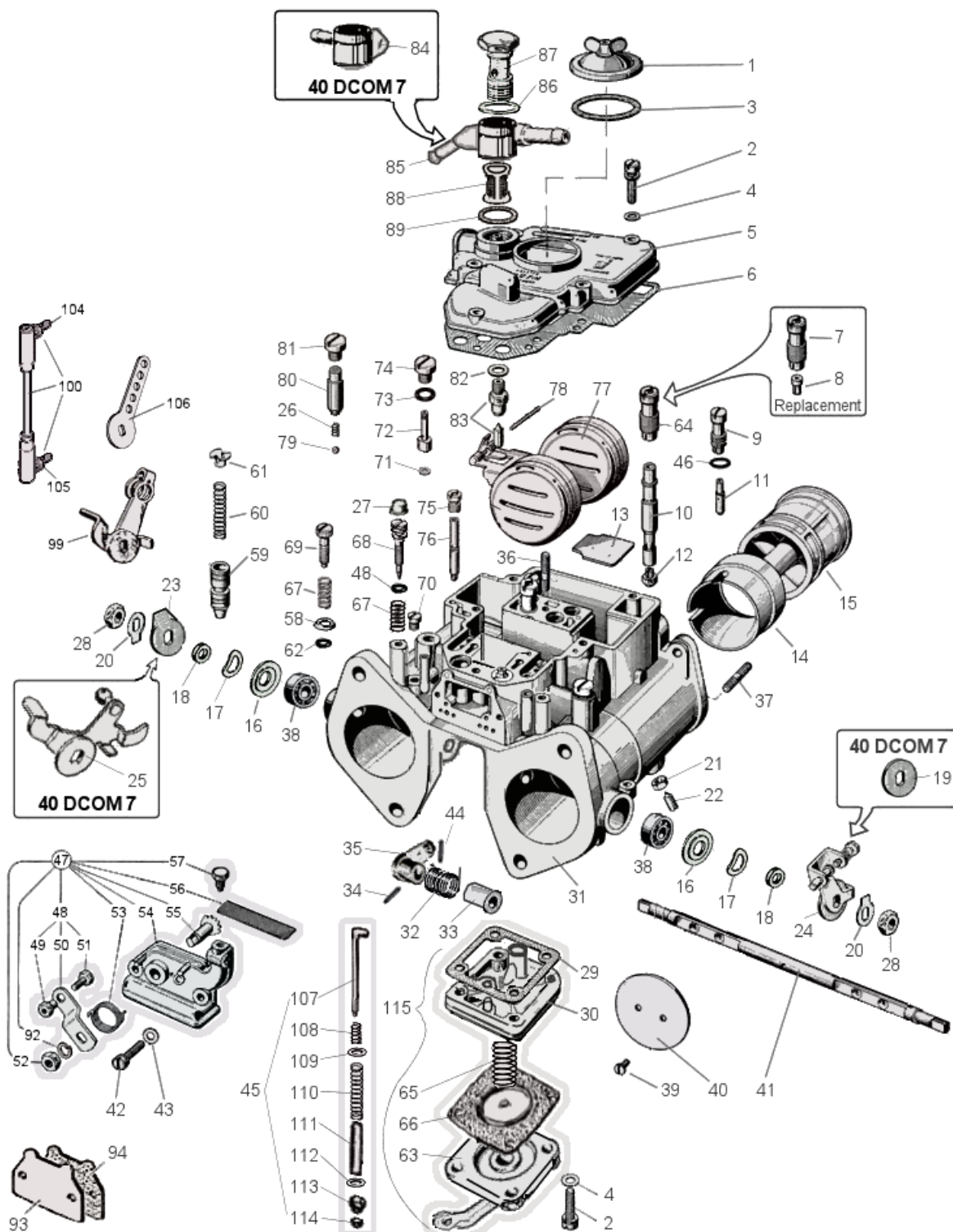

## WEBER 40 DCOM 6/7 - exploded view





**CarbDeal**  
Selling carburetor parts since 2005



## WEBER 40 DCOM 6/7 - Parts list

No	Part No	Price	Pcs	Description	No	Part No	Price	Pcs	Description
1	32376.003	€ 7.9	1	Jet Cover	54	32556.001	€ 0	1	Cold Start Unit Body
2	64700.001	€ 0.5	9	Cover Screw	55	10085.003	€ 0	1	Shaft
3	41550.002	€ 2.5	1	Gasket	56	37000.016	€ 3.8	1	Filter Screen
4	55510.034	€ 0.4	5	Washer	57	64605.017	€ 1.8	1	Fixing Bolt
5		€ 0	1	Carb Top Cover	58	58000.006	€ 1.8	1	Cup washer
6	41715.011	€ 1.7	1	Carb. Cover Gasket	59	64330.014	€ 5.8	2	Starter Valve
7	52580.001	€ 4.6	2	Emulsion Tube Holder	60	47600.243	€ 4.4	2	Starter Valve Spring
8	77401	€ 4.3	2	Air Corrector Jet	61	52030.003	€ 2.9	2	Spring Retainer
9	52585.005	€ 17.6	2	Idle Jet Holder	62	41565.002	€ 0.4	2	O ring
10	61450.261	€ 0	2	Emulsion Tube	63		€ 0	1	Pump bottom
11	74800	€ 2.9	2	Idle Jet	64	77511.160	€ 0	2	Emulsion tube holder with air corrector
12	73401	€ 12.5	2	Main Jet	65	47600.250	€ 5	1	Pump Spring
13	52130.003	€ 1.7	1	Plate	66	47407.267	€ 11.7	1	Pump Diaphragm
14	72303.320	€ 0	2	Choke Tube	67	47600.007	€ 2.2	2	Idle Screw Spring
15	69909.600	€ 57.3	2	Auxiliary Venturi	68	64750.058	€ 5	2	Idle Mixture Screw
16	41570.001	€ 1	2	Dust Cover	69	64625.012	€ 5.4	1	Throttle stop screw
17	47600.063	€ 1.8	2	Spring	70	61015.002	€ 5	2	Progression Hole Plug
18	58000.007	€ 2.7	2	Retaining Cover	71	41535.021	€ 1.1	2	Pump Gasket
19	55555.010	€ 1.7	1	Washer	72	76818.035	€ 4.8	2	Pump Jet
20	55520.004	€ 1	2	Lock washer	73	41565.009	€ 0.6	2	Pump Cover Seal
21	34710.003	€ 1	1	Lock Nut	74	61015.008	€ 7.5	2	Pump Cover
22	64830.006	€ 3.7	1	Locking screw	75	77505.150	€ 5.8	1	Starter air jet
23		€ 0	1	Stop washer	76	75507.085	€ 10	2	Starter Jet
24	45048.149	€ 15	1	Balance lever	77	41030.005	€ 33	1	Float
25		€ 0	1	Throttle lever	78	52000.001	€ 1.6	1	Float Fulcrum Pin
26	47600.296	€ 0	1	Spring	79	58300.003	€ 2.1	2	Pump Valve Ball
27	61075.021	€ 0	1	Mixture screw cap	80	52730.004	€ 9.2	2	Stuffing Ball
28	34710.003	€ 1	2	Shaft Nut	81	61015.002	€ 5	2	Retaining Screw
29	41640.069	€ 2.5	1	Gasket	82	83102.120	€ 0.3	1	Needle Valve Gasket
30		€ 0	1	Bottom Bowl Cover	83	79503	€ 7.9	1	Needle Valve
31		€ 0	1	Carburetor Body	84		€ 0	1	Fuel Union
32		€ 0	1	Throttle return spring	85		€ 0	1	Fuel Union
33		€ 0	1	Pump spring insert	86	41530.024	€ 0.3	1	Outer Fuel Union Gasket
34	58445.001	€ 0.4	1	Pin	87	12715.008	€ 7.5	1	Fuel Union Bolt
35		€ 0	1	Pump Control Lever	88	37022.010	€ 3.7	1	Fuel Filter
36	64955.007	€ 11.6	1	Stud	89	41530.024	€ 0.3	1	Gasket
37	64955.101	€ 12.5	1	Stud	92	55525.010	€ 0.4	1	Washer
38	32650.001	€ 3.3	2	Throttle Shaft Bearing	93	52135.008	€ 2.5	1	Blanking plate
39	64570.006	€ 2.1	4	Throttle Plate Screw	94	ST2283	€ 0.8	1	Blanking plate gasket
40	64005.059	€ 7.9	2	Throttle Plate	99	45048.007	€ 11.9	1	Throttle lever
41	10005.438	€ 24.2	1	Throttle Shaft	100	ST2559	€ 18.4	1	Rod with ball ends
42	64700.004	€ 2	2	Cold Start Fixing Screw	104	ST2460	€ 4.2	1	Ball end Left thread
43	55510.038	€ 0	2	Flat Washer	105	ST1937	€ 4.2	1	Ball end Right thread
44	58445.001	€ 0.4	1	Fixing pin	106	ST1936	€ 5	1	Universal lever
45	92433.805	€ 0	1	Pump rod	107		€ 0		Pump rod
46	41565.002	€ 0.4	1	O ring	108		€ 0		Spring
47	32556.018	€ 37.5	1	Cold Start Unit	109		€ 0		Washer
48	41565.002	€ 0.4	2	O ring	110		€ 0		Spring
49	34720.002	€ 0	1	Nut	111		€ 0		Pump rod insert
50	45025.029	€ 0	1	Lever	112		€ 0		Washer
51	64800.002	€ 0	1	Wire screw	113		€ 0		
52	34715.010	€ 0	1	Nut	114		€ 0		
53	47610.006	€ 6.3	1	Return Spring	115	39174.020	€ 0	1	Pump assembly

<https://www.carbparts.eu>

Prices and product availability are subject to change

