

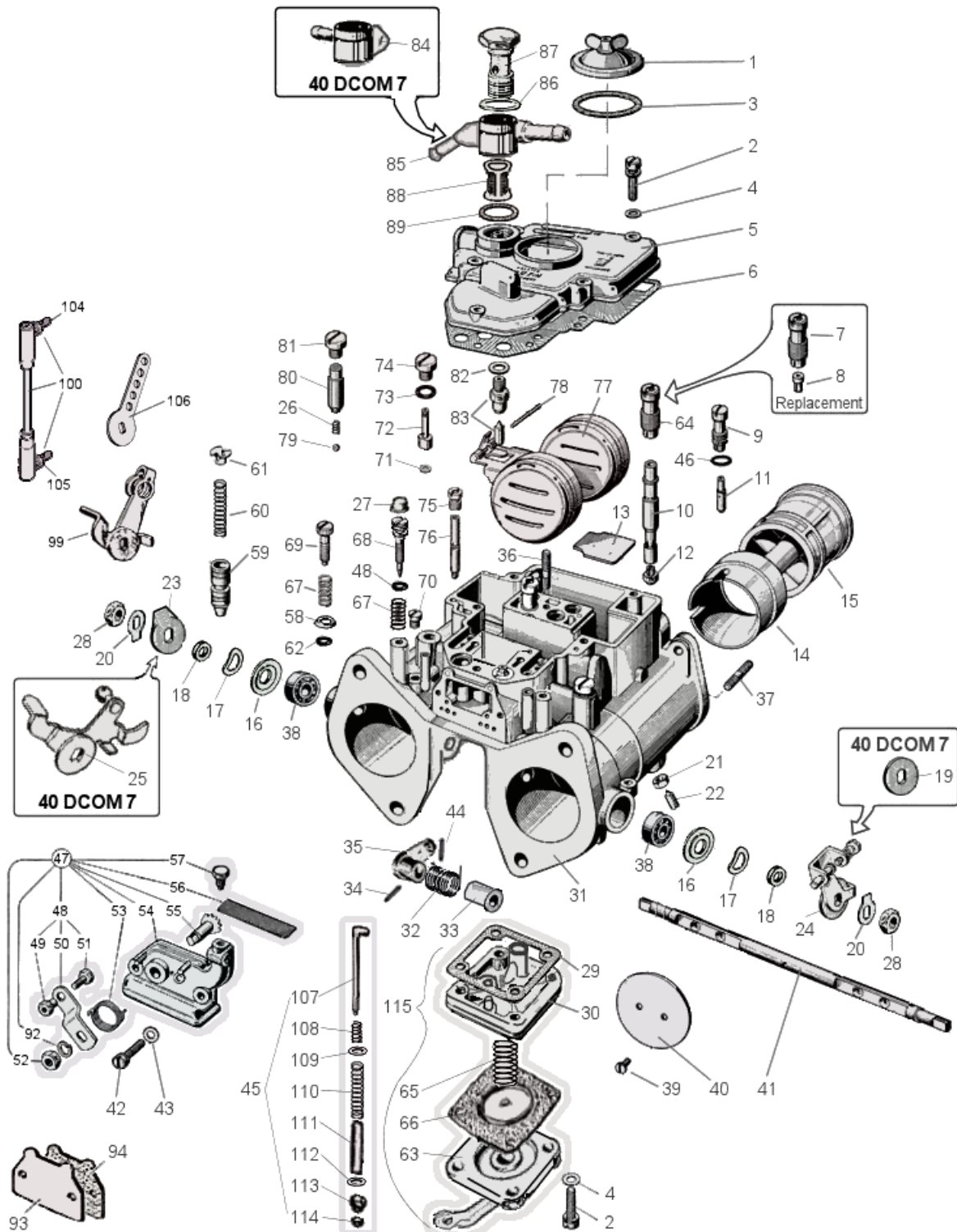

WEBER 40 DCOM 6/7

Exploded view



<https://www.carbparts.eu>

Prices and product availability are subject to change



WEBER 40 DCOM 6/7

List of parts



No	Part No	Price	Pcs	Description
1	32376.003	\$ 12	1	Jet Cover
2	64700.001	\$ 0.6	9	Cover Screw
3	41550.002	\$ 1.1	1	Gasket
4	55510.034	\$ 0.4	5	Washer
5		\$ 0	1	Carb Top Cover
6	41715.011	\$ 2.6	1	Carb. Cover Gasket
7	52580.001	\$ 7.3	2	Emulsion Tube Holder
8	77401	\$ 5	2	Air Corrector Jet
9	52585.005	\$ 20.4	2	Idle Jet Holder
10	61450.261	\$ 0	2	Emulsion Tube
11	74800	\$ 3.3	2	Idle Jet
12	73401	\$ 4.2	2	Main Jet
13	52130.003	\$ 2.6	1	Plate
14	72303.320	\$ 0	2	Choke Tube
15	69909.600	\$ 63.2	2	Auxiliary Venturi
16	41570.001	\$ 1.1	2	Dust Cover
17	47600.063	\$ 2.1	2	Spring
18	58000.007	\$ 3	2	Retaining Cover
19	55555.010	\$ 2.6	1	Washer
20	55520.004	\$ 1.1	2	Lock washer
21	34710.003	\$ 1.1	1	Lock Nut
22	64830.006	\$ 4.1	1	Locking screw
23		\$ 0	1	Stop washer
24	45048.149	\$ 23.8	1	Balance lever
25		\$ 0	1	Throttle lever
26	47600.296	\$ 0	1	Spring
27	61075.021	\$ 0	1	Mixture screw cap
28	34710.003	\$ 1.1	2	Shaft Nut
29	41640.069	\$ 4	1	Gasket
30		\$ 0	1	Bottom Bowl Cover
31		\$ 0	1	Carburetor Body
32		\$ 0	1	Throttle return spring
33		\$ 0	1	Pump spring insert
34	58445.001	\$ 0.4	1	Pin
35		\$ 0	1	Pump Control Lever
36	64955.007	\$ 12.8	1	Stud
37	64955.101	\$ 19.8	1	Stud
38	32650.001	\$ 5.2	2	Throttle Shaft Bearing
39	64570.006	\$ 3.3	4	Throttle Plate Screw
40	64005.059	\$ 12.5	2	Throttle Plate
41	10005.438	\$ 38.3	1	Throttle Shaft
42	64700.004	\$ 3.2	2	Cold Start Fixing Screw
43	55510.038	\$ 0	2	Flat Washer
44	58445.001	\$ 0.4	1	Fixing pin
45	92433.805	\$ 0	1	Pump rod
46	41565.002	\$ 0.4	1	O ring
47	32556.018	\$ 38.5	1	Cold Start Unit
48	41565.002	\$ 0.4	2	O ring
49	34720.002	\$ 9.2	1	Nut
50	45025.029	\$ 0	1	Lever
51	64800.002	\$ 0	1	Wire screw
52	34715.010	\$ 0	1	Nut
53	47610.006	\$ 9.9	1	Return Spring

No	Part No	Price	Pcs	Description
54	32556.001	\$ 0	1	Cold Start Unit Body
55	10085.003	\$ 0	1	Shaft
56	37000.016	\$ 5.9	1	Filter Screen
57	64605.017	\$ 2	1	Fixing Bolt
58	58000.006	\$ 2.1	1	Cup washer
59	64330.014	\$ 9.2	2	Starter Valve
60	47600.243	\$ 4.9	2	Starter Valve Spring
61	52030.003	\$ 4.6	2	Spring Retainer
62	41565.002	\$ 0.4	2	O ring
63		\$ 0	1	Pump bottom
64	77511.160	\$ 0	2	Emulsion tube holder with air corrector
65	47600.250	\$ 8	1	Pump Spring
66	47407.267	\$ 18.5	1	Pump Diaphragm
67	47600.007	\$ 2.5	2	Idle Screw Spring
68	64750.058	\$ 7.9	2	Idle Mixture Screw
69	64625.012	\$ 8.6	1	Throttle stop screw
70	61015.002	\$ 7.9	2	Progression Hole Plug
71	41535.021	\$ 1.3	2	Pump Gasket
72	76818.035	\$ 10.2	2	Pump Jet
73	41565.009	\$ 0.7	2	Pump Cover Seal
74	61015.008	\$ 11.9	2	Pump Cover
75	77505.150	\$ 9.2	1	Starter air jet
76	75507.085	\$ 15.8	2	Starter Jet
77	41030.005	\$ 33	1	Float
78	52000.001	\$ 2.5	1	Float Fulcrum Pin
79	58300.003	\$ 0.3	2	Pump Valve Ball
80	52730.004	\$ 10.1	2	Stuffing Ball
81	61015.002	\$ 7.9	2	Retaining Screw
82	83102.120	\$ 0.3	1	Needle Valve Gasket
83	79503	\$ 12.5	1	Needle Valve
84		\$ 0	1	Fuel Union
85		\$ 0	1	Fuel Union
86	41530.024	\$ 0.3	1	Outer Fuel Union Gasket
87	12715.008	\$ 9	1	Fuel Union Bolt
88	37022.010	\$ 5.7	1	Fuel Filter
89	41530.024	\$ 0.3	1	Gasket
92	55525.010	\$ 0.4	1	Washer
93	52135.008	\$ 5	1	Blanking plate
94	ST2283	\$ 1.3	1	Blanking plate gasket
99	45048.007	\$ 13.5	1	Throttle lever
100	ST2559	\$ 29	1	Rod with ball ends
104	ST2460	\$ 6.6	1	Ball end Left thread
105	ST1937	\$ 6.6	1	Ball end Right thread
106	ST1936	\$ 7.9	1	Universal lever
107		\$ 0		Pump rod
108		\$ 0		Spring
109		\$ 0		Washer
110		\$ 0		Spring
111		\$ 0		Pump rod insert
112		\$ 0		Washer
113		\$ 0		
114		\$ 0		
115	39174.020	\$ 0	1	Pump assembly

<https://www.carbparts.eu>

Prices and product availability are subject to change