

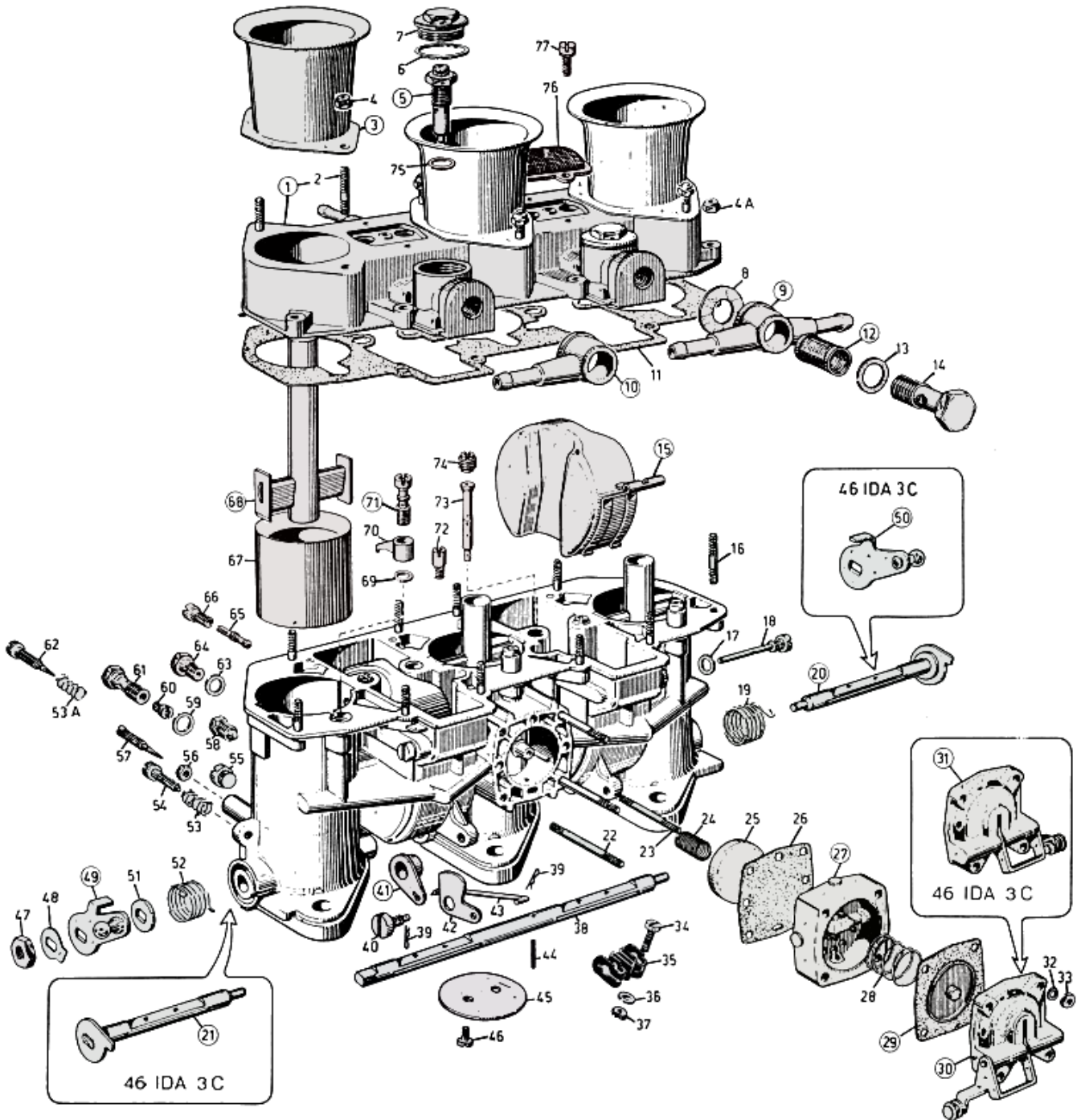

WEBER 40 IDA 3C - exploded view



<https://www.carbparts.eu>

Prices and product availability are subject to change



CarbDeal
Selling carburetor parts since 2005



WEBER 40 IDA 3C - Parts list

No	Part No	Price	Pcs	Description	No	Part No	Price	Pcs	Description
1	-	\$ 0	1	Carburetor Cover	39	32610.006	\$ 0	2	Split Pin
2	64955.002	\$ 8.9	6	Stud	40	64895.003	\$ 0	1	Fulcrum Screw
3	52845.005	\$ 0	6	Air Intake	41	45027.007	\$ 0	1	Lever
4a	34725.003	\$ 2.1	10	Nut	42	61287.001	\$ 0	1	Tie Rod 40 IDA 3C1
4	34725.003	\$ 2.1	6	Nut	43	41565.002	\$ 0.5	3	O' Ring
5	79508	\$ 15	2	Needle Valve	44	58445.001	\$ 0.5	1	Spring Pin
6	41530.035	\$ 5.5	2	Gasket	45	64005.126	\$ 31.3	3	Throttle
7	61002.005	\$ 29.2	2	Plug	46	64520.027	\$ 0.7	6	Screw
8	41530.004	\$ 0	2	Gasket	47	34715.007	\$ 0	1	Nut
9	10356.005	\$ 44.1	1	Filter Body	48	55520.008	\$ 0	1	Washer
10	10356.002	\$ 44.1	1	Filter Body	49	45034.028	\$ 0	1	Control Lever 40 IDA 3C1
11	41710.001	\$ 7.1	1	Gasket	50	45034.027	\$ 0	1	Control Lever 40 IDA 3C
12	37022.001	\$ 23.8	2	Filter Gauze	51	55555.019	\$ 1.7	1	Washer
13	41530.001	\$ 2	2	Gasket	52	47610.071	\$ 4.5	1	Spring
14	12715.014	\$ 33.7	2	Plug	53a	47600.007	\$ 2.6	3	Spring
15	41015.007	\$ 24	2	Float	53	47600.007	\$ 2.6	1	Spring
16	64995.030	\$ 0	9	Stud	54	64590.005	\$ 0	1	Throttle Adjusting Screw
17	41540.016	\$ 0	2	Gasket	55	61015.009	\$ 6	3	Progression Hole Inspection Screw
18	64900.012	\$ 25.4	2	Fulcrum Screw	56	34705.001	\$ 0.9	3	Nut
19	47610.072	\$ 4.5	1	Spring	57	64570.002	\$ 0	3	Air Adjusting Screw
20	10015.419	\$ 0	1	Spindle 40IDA 3 c1	58	64840.003	\$ 4	3	Choke Fixing Screw
20a	-	\$ 0	1	Oversize Spindle 40 ida 3c1	59	41540.001	\$ 2	3	Gasket
21a	-	\$ 0	1	Oversize Spindle 40 ida 3c1	60	73801	\$ 3.2	3	Main Jet
21	10015.415	\$ 0	1	Spindle 40 ida 3c	61	52590.001	\$ 22.5	3	Jet Holder
22	64955.011	\$ 0	2	Stud	62	64750.004	\$ 18.8	3	Idle Mixture Adjusting Screw
23	64955.020	\$ 0	2	Stud	63	41530.006	\$ 0	2	Gasket
24	47600.128	\$ 0	1	Spring	64	61002.006	\$ 3.5	2	Plug
25	64190.004	\$ 0	1	Pump Valve	65	74403	\$ 3	3	Idling Jet
26	47405.011	\$ 2.1	1	Diaphragm	66	52570.005	\$ 7.4	3	Jet Holder
27	39174.002	\$ 0	1	Pump Body	67	71502	\$ 24	3	Choke
28	47600.012	\$ 0	1	Spring	68	71103.450	\$ 110	3	Secondary Venturi
29	47407.010	\$ 30.7	1	Diaphragm	69	41540.014	\$ 2.9	3	Gasket
30	32486.009	\$ 0	1	Pump Cover 40IDA 3C1	70	76201	\$ 11	3	Pump Jet
31	32486.010	\$ 0	1	Pump Cover 40IDA 3C1	71	64290.005	\$ 19.4	3	Delivery Valve
32	55525.007	\$ 1	4	Spring Washer	72	79701	\$ 7.9	1	Intake Valve
33	34705.003	\$ 0	4	Nut	73	61440	\$ 16.6	3	Emulsion Tube
34	61287.002	\$ 0	1	Tie Rod 40 IDA 3C	74	77201	\$ 2.6	3	Air Corrector Jet
35	32272.001	\$ 0	1	Joint Coupler (Aluminum Style)	75	41530.005	\$ 0	2	Gasket
36	64600.001	\$ 0	4	Screw	76	64955.030	\$ 7.3	1	Stud
37	55510.018	\$ 0	3	Washer	77	52150.006	\$ 0	1	Plate
38	10005.407	\$ 96.4	1	Spindle					

<https://www.carbparts.eu>

Prices and product availability are subject to change

