

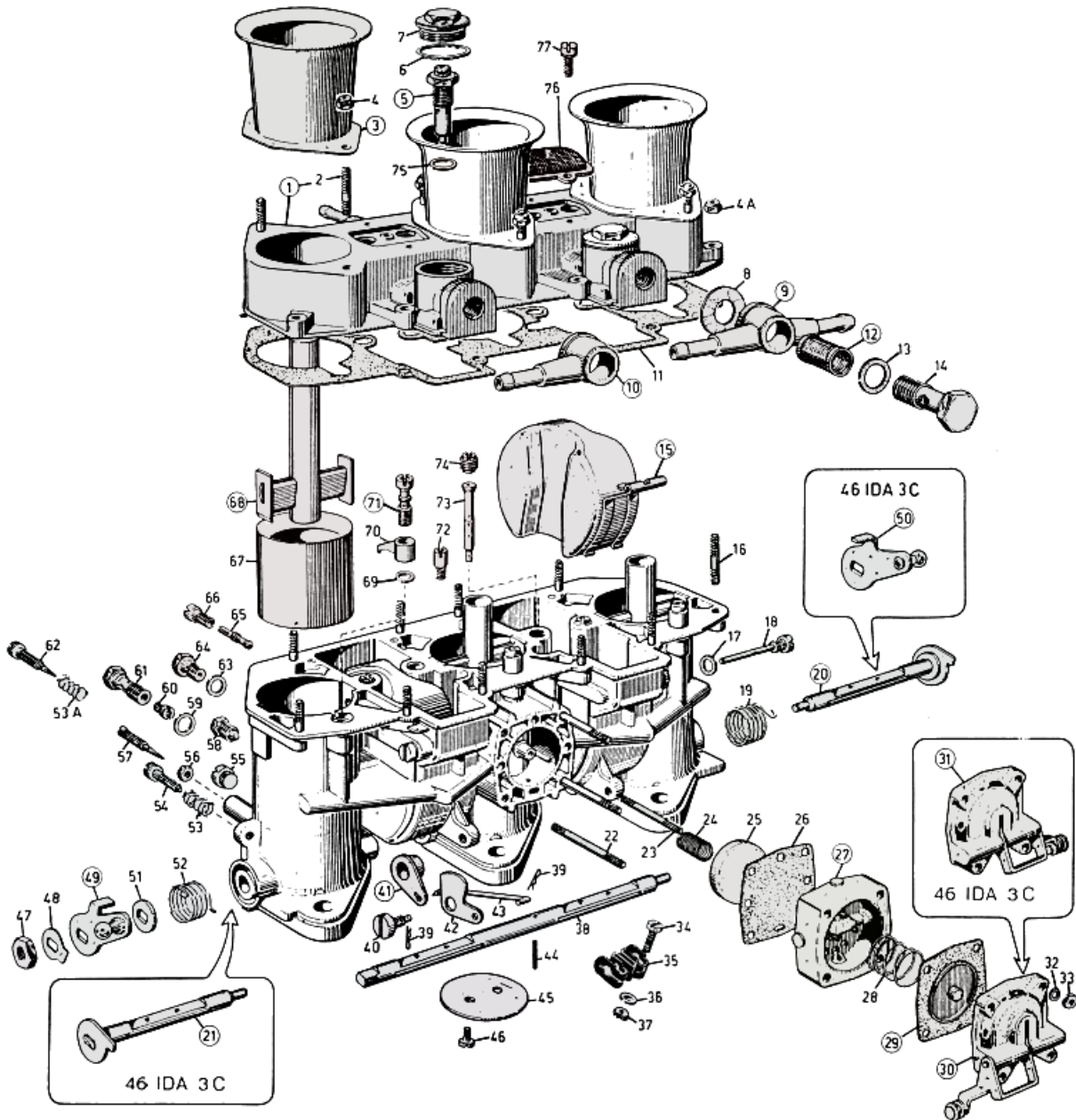

WEBER 40 IDA 3C

Exploded view



<https://www.carbparts.eu>

Prices and product availability are subject to change



WEBER 40 IDA 3C

List of parts



No	Part No	Price	Pcs	Description
1	-	\$ 0	1	Carburetor Cover
2	64955.002	\$ 8.2	6	Stud
3	52845.005	\$ 0	6	Air Intake
4a	34725.003	\$ 0.7	10	Nut
4	34725.003	\$ 0.7	6	Nut
5	79508	\$ 19.8	2	Needle Valve
6	41530.035	\$ 5	2	Gasket
7	61002.005	\$ 26.8	2	Plug
8	41530.004	\$ 0	2	Gasket
9	10356.005	\$ 40.5	1	Filter Body
10	10356.002	\$ 40.5	1	Filter Body
11	41710.001	\$ 6.7	1	Gasket
12	37022.001	\$ 21.9	2	Filter Gauze
13	41530.001	\$ 1.9	2	Gasket
14	12715.014	\$ 31	2	Plug
15	41015.007	\$ 31.7	2	Float
16	64995.030	\$ 0	9	Stud
17	41540.016	\$ 0	2	Gasket
18	64900.012	\$ 23.4	2	Fulcrum Screw
19	47610.072	\$ 4.3	1	Spring
20a	-	\$ 0	1	Oversize Spindle 40 ida 3c1
20	10015.419	\$ 0	1	Spindle 40IDA 3 c1
21	10015.415	\$ 0	1	Spindle 40 ida 3c
21a	-	\$ 0	1	Oversize Spindle 40 ida 3c1
22	64955.011	\$ 0	2	Stud
23	64955.020	\$ 0	2	Stud
24	47600.128	\$ 0	1	Spring
25	64190.004	\$ 0	1	Pump Valve
26	47405.011	\$ 2	1	Diaphragm
27	39174.002	\$ 0	1	Pump Body
28	47600.012	\$ 0	1	Spring
29	47407.010	\$ 28.2	1	Diaphragm
30	32486.009	\$ 0	1	Pump Cover 40IDA 3C1
31	32486.010	\$ 0	1	Pump Cover 40IDA 3C1
32	55525.007	\$ 0.9	4	Spring Washer
33	34705.003	\$ 0	4	Nut
34	61287.002	\$ 0	1	Tie Rod 40 IDA 3C
35	32272.001	\$ 0	1	Joint Coupler (Aluminum Style)
36	64600.001	\$ 0	4	Screw
37	55510.018	\$ 0	3	Washer
38	10005.407	\$ 88.7	1	Spindle

No	Part No	Price	Pcs	Description
39	32610.006	\$ 0	2	Split Pin
40	64895.003	\$ 0	1	Fulcrum Screw
41	45027.007	\$ 0	1	Lever
42	61287.001	\$ 0	1	Tie Rod 40 IDA 3C1
43	41565.002	\$ 0.4	3	O' Ring
44	58445.001	\$ 0.4	1	Spring Pin
45	64005.126	\$ 28.8	3	Throttle
46	64520.027	\$ 0.7	6	Screw
47	34715.007	\$ 0	1	Nut
48	55520.008	\$ 0	1	Washer
49	45034.028	\$ 0	1	Control Lever 40 IDA 3C1
50	45034.027	\$ 21.4	1	Control Lever 40 IDA 3C
51	55555.019	\$ 1.6	1	Washer
52	47610.071	\$ 4.3	1	Spring
53a	47600.007	\$ 2.5	3	Spring
53	47600.007	\$ 2.5	1	Spring
54	64590.005	\$ 0	1	Throttle Adjusting Screw
55	61015.009	\$ 7.9	3	Progression Hole Inspection Screw
56	34705.001	\$ 0.8	3	Nut
57	64570.002	\$ 0	3	Air Adjusting Screw
58	64840.003	\$ 5.3	3	Choke Fixing Screw
59	41540.001	\$ 1.9	3	Gasket
60	73801	\$ 4.2	3	Main Jet
61	52590.001	\$ 20.7	3	Jet Holder
62	64750.004	\$ 17.3	3	Idle Mixture Adjusting Screw
63	41530.006	\$ 0	2	Gasket
64	61002.006	\$ 4.6	2	Plug
65	74403	\$ 4	3	Idling Jet
66	52570.005	\$ 7	3	Jet Holder
67	71502	\$ 31.7	3	Choke
68	71103.450	\$ 101	3	Secondary Venturi
69	41540.014	\$ 2.6	3	Gasket
70	76201	\$ 12.4	3	Pump Jet
71	64290.005	\$ 25.3	3	Delivery Valve
72	79701	\$ 10.4	1	Intake Valve
73	61440	\$ 15.7	3	Emulsion Tube
74	77201	\$ 3.4	3	Air Corrector Jet
75	41530.005	\$ 0	2	Gasket
76	64955.030	\$ 6.7	1	Stud
77	52150.006	\$ 0	1	Plate

<https://www.carbparts.eu>

Prices and product availability are subject to change