

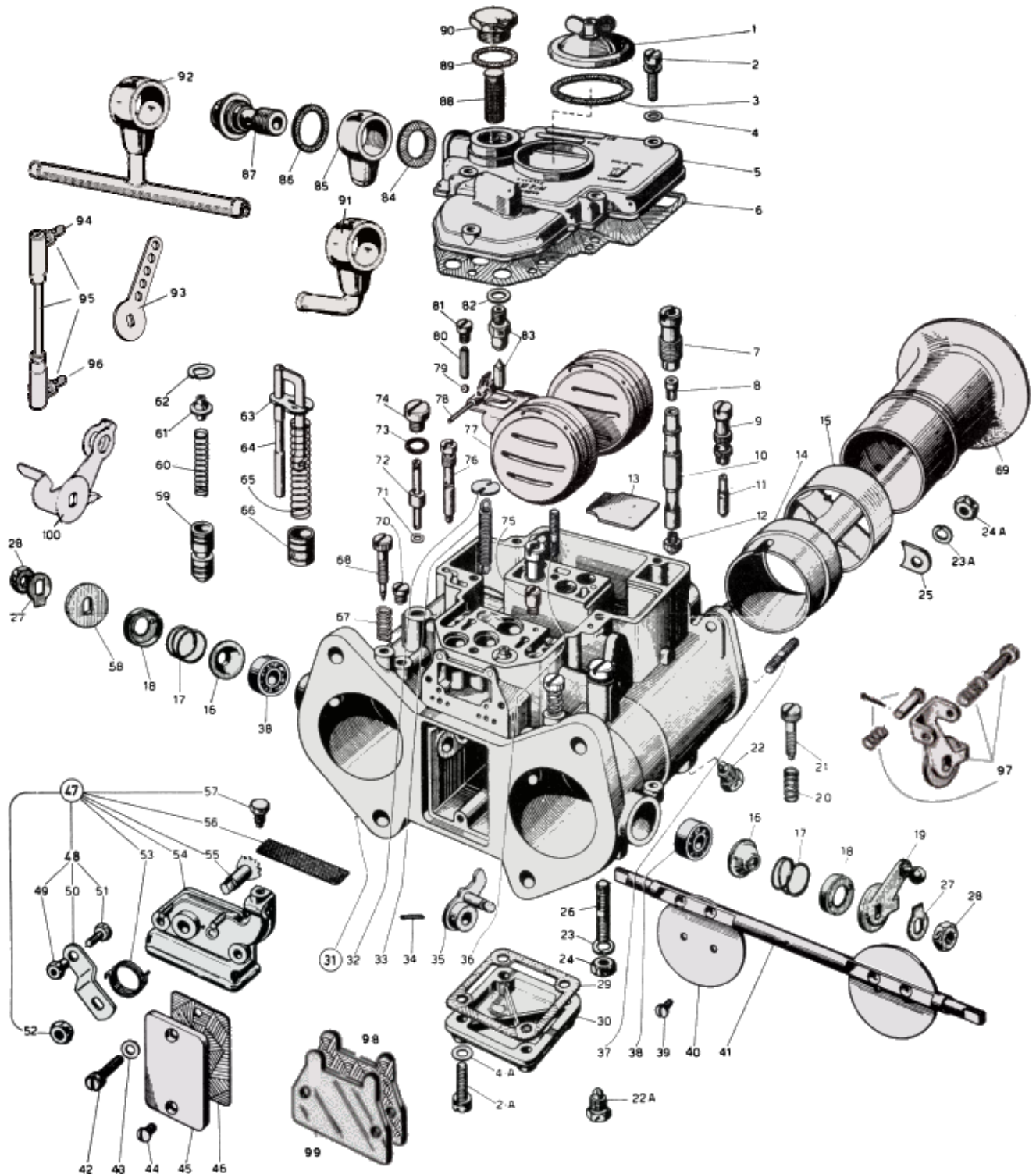

WEBER 45 DCOE early - exploded view



<https://www.carbparts.eu>

Prices and product availability are subject to change



CarbDeal
Selling carburetor parts since 2005



WEBER 45 DCOE early - Parts list

No	Part No	Price	Pcs	Description	No	Part No	Price	Pcs	Description
1	32376.003	£ 6.8	1	Jets inspection cover	49	34720.002	£ 0	1	— Nut for screw
2	64700.001	£ 0.5	5	Screw securing carburetor cover	50	45025.029	£ 0	1	— Starter lever
2 A	64700.001	£ 0.5	4	Securing screw for well-bottom cover	51	64800.002	£ 0	1	— Cable securing screw
3	41550.002	£ 2.2	1	Gasket for jets inspection cover	52	34715.010	£ 0	1	— Lever securing nut
4 A	55510.034	£ 0.4	4	Normal washer	53	47610.006	£ 5.4	1	— Lever return spring
4	55510.034	£ 0.4	5	Normal washer	54	32556.001	£ 0	1	— Cover for sheath support
5	31734.025	£ 0	1	Carburetor cover	55	10085.003	£ 0	1	— Starter shaft
6	41715.001	£ 3.6	1	Gasket for carburetor cover	56	37000.016	£ 3.2	1	— Strainer
7	52580.001	£ 4	2	Emulsifying tube holder	57	64605.017	£ 1.5	1	— Sheath securing screw
8	77401	£ 3.7	2	Air corrector jet	58	55555.010	£ 1.4	1	Shim washer
9	52585.006	£ 4.7	2	Idling jet-holder	59	64330.003	£ 5	2	Starter valve
10	61450	£ 20.9	2	Emulsifying tube	60	47600.005	£ 2.5	2	Spring for starter valve
11	74819	£ 0	2	Idling jet	61	12775.004	£ 2.5	2	Spring retainer and guide
12	73401	£ 10.8	2	Main jet	62	10140.010	£ 2.7	2	Spring washer
13	52130.003	£ 1.4	1	Plate for carburetor bowl	63	52140.004	£ 2.2	1	Spring retaining plate
14	72116	£ 7.9	2	Choke	64	10410.015	£ 6.5	1	Pump control rod
15	69602	£ 0	2	Auxiliary venturi	65	47600.064	£ 4	1	Spring for plunger
16	41570.001	£ 0.9	2	Dust cover	66	58602.003	£ 6.4	1	Pump plunger
17	47600.063	£ 1.6	2	Spring	67	47600.007	£ 1.9	2	Spring for idling adjustment screw
18	58000.007	£ 2.3	2	Spring retaining cover	68	64750.001	£ 2.2	2	Idling adjustment screw
19	45034.044	£ 0	1	Throttle control lever	69	52840.001	£ 14.2	2	Air intake horn
20	47600.007	£ 1.9	1	Throttle adjusting spring	70	61015.002	£ 4.3	2	Screw for progression holes inspection
21	64590.002	£ 7.9	1	Throttle adjusting screw	71	41535.021	£ 1	2	Gasket for pump jet
22 A	64840.003	£ 2.9	2	Choke fixing screw	72	76801	£ 4	2	Pump jet
22	64340.003	£ 0	2	Auxiliary venturi fixing screw	73	41565.009	£ 0.5	2	Seal
23	55525.002	£ 0	1	Spring washer	74	61015.008	£ 6.5	2	Screw plug
23 A	55525.002	£ 0	4	Spring washer	75	79701	£ 5.7	1	Intake and discharge valve
24 A	34705.004	£ 0.5	4	Nut for air intake	76	75606	£ 8.6	2	Starter jet
24	34705.004	£ 0.5	1	Carburetor anchoring nut	77	41030.004	£ 28.4	1	Float
25	52150.004	£ 8.6	4	Retaining plate for air intake	78	52000.001	£ 1.4	1	Fulcrum pin
26	64955.104	£ 0	1	Stud bolt	79	58300.001	£ 0.7	2	Ball for valve
27	55520.004	£ 0.9	2	Lock washer	80	52730.001	£ 2.8	2	Stuffing ball
28	34710.003	£ 0.9	2	Hexagonal nut	81	61015.006	£ 2.8	2	Retaining screw for stuffing ball
29	41640.001	£ 2.2	1	Gasket for cap	82	41535.015	£ 0	1	Gasket for needle valve
30	32374.008	£ 10.1	1	Cap for bottom of bowl	83	79401	£ 0	1	Needle valve
31	-	£ 0	1	Carburetor body	84	41530.031	£ 0.2	1	Gasket for union
32	52210.006	£ 1.3	1	Spring anchoring plate	85	10354.001	£ 0	1	Spherical union
33	47605.012	£ 1.4	1	Spindle return spring	86	41530.024	£ 0.2	1	Gasket for union
34	58445.001	£ 0.4	1	Lever fixing pin	87	12715.008	£ 6.5	1	Screw plug for union
35	45082.005	£ 12.2	1	Pump control lever	88	37022.002	£ 3.2	1	Strainer
36	64955.007	£ 10.1	1	Stud bolt	89	41530.024	£ 0.2	1	Gasket for filter plug
37	64955.101	£ 10.8	4	Stud bolt	90	61002.010	£ 5.4	1	Filter inspection plug
38	32650.001	£ 2.8	2	Ball bearing	91	10536.035	£ 5.8	1	Fuel Union L pipe
39	64570.006	£ 1.8	4	Throttle securing screw	92	10536.034	£ 9.9	1	Fuel inlet T pipe
40	64005.069	£ 29.7	2	Throttle valve	93	ST1936	£ 4.3	1	Universal lever
41	10005.401	£ 20.9	1	Throttle spindle	94	ST2460	£ 3.6	1	Ball end Left thread
42	64700.004	£ 1.7	2	Starter control securing screw	95	ST2559	£ 15.8	1	Rod with ball ends
43	55510.038	£ 0	2	Normal washer	96	ST1937	£ 3.6	1	Ball end Right thread
44	64570.009	£ 0.6	2	Cap securing screw	97	45048.149	£ 13	1	Balance lever
45	52135.002	£ 3.6	1	Cap for pump opening	98	ST2283	£ 0.7	1	Blanking plate gasket
46	41640.021	£ 0.7	1	Gasket for cap	99	52135.008	£ 2.2	1	Blanking plate
47	32556.002	£ 32.4	1	Starter control, including:	100	45048.007	£ 10.4	1	Throttle lever
48	45027.030	£ 0	1	— Starter control lever, complete with:					

<https://www.carbparts.eu>

Prices and product availability are subject to change

