

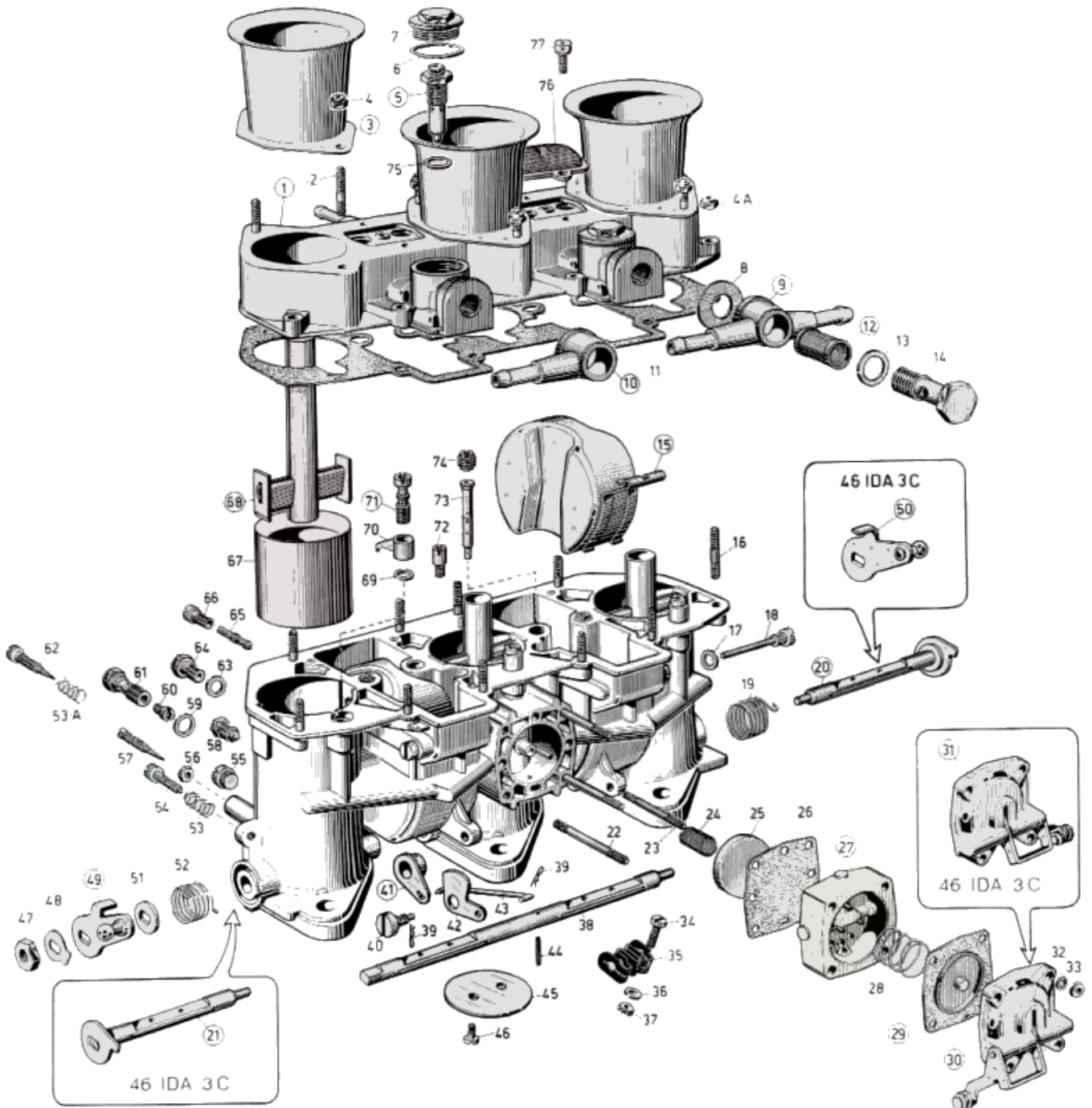

WEBER 46 IDA 3C - exploded view



<https://www.carbparts.eu>

Prices and product availability are subject to change



CarbDeal
Selling carburetor parts since 2005



WEBER 46 IDA 3C - Parts list

No	Part No	Price	Pcs	Description	No	Part No	Price	Pcs	Description
1	31726.001	£ 0	1	Carburetor cover including	38	10005.412	£ 0	1	Spindle
2	64955.014	£ 0	6	Stud	39	32610006	£ 0	2	Spilt pin
3	52845.006	£ 0	3	Air intake	40	64895.002	£ 0	1	Fulcrum screw
4-A	34725.003	£ 1.5	10	Nut	41	45027.007	£ 0	1	Lever
4	34725.003	£ 1.5	6	Nut	42	14855.003	£ 0	1	Cam
5	64240.009	£ 10.8	2	Needle valve	43	61280.031	£ 0	1	Tie rod
6	41530.035	£ 3.9	2	Gasket	44	58445.001	£ 0.4	1	Spring pin
7	61002.005	£ 21.1	2	Plug	45	64005.006	£ 0	3	Throttle
8	41530.004	£ 0	2	Gasket	46	64520.027	£ 0.5	6	Screw
9	10356.005	£ 31.9	1	Filter Body	47	34715.014	£ 0.9	1	Nut
10	10356.002	£ 31.9	1	Filter Body	48	55520.002	£ 0.9	1	Washer
11	41710.001	£ 5.2	1	Gasket	49	45034.007	£ 0	1	Control Lever - 46 IDA 3C1
12	37022.001	£ 17.2	2	Filter Gauze	50	45034.011	£ 0	1	Control Lever - 46 IDA 3C
13	41530.001	£ 1.5	2	Gasket	51	55555.019	£ 1.3	1	Washer
14	12715.014	£ 24.4	2	Plug	52	47610.071	£ 3.3	1	Spring
15	41015.007	£ 17.2	2	Float	53	47600.007	£ 1.9	1	Spring
16	64955.012	£ 0	10	Stud	53-A	47600.007	£ 1.9	3	Spring
17	41530.017	£ 0	2	Gasket	54	64590.002	£ 7.9	1	Throttle adjusting screw
18	64900.012	£ 18.4	2	Fulcrum screw	55	61015.009	£ 4.3	3	Progression hole inspection screw
19	47610.072	£ 3.3	1	Spring	56	34705.001	£ 0.6	3	Nut
20	10016.442	£ 0	1	Spindle oversize - 46 IDA 3C1 .	57	64750.002	£ 5.4	3	Air adjusting screw
20	10015.458	£ 0	1	Spindle 46 IDA 3C1	58	64840.001	£ 0	3	Choke fixing screw
21	10016.443	£ 0	1	Spindle oversize - 45 IDA 3C	59	41540.001	£ 1.5	3	Gasket
21	10015.457	£ 0	1	Spindle 46 IDA 3C	60	41120.001	£ 2.3	3	Main jet
22	64955.011	£ 0	2	Stud	61	52590.001	£ 16.3	3	Jet holder
23	64955.017	£ 0	2	Stud	62	64750.001	£ 2.2	3	Idling mixture adjusting screw
24	47600.128	£ 0	1	Spring	63	41530.008	£ 0	2	Gasket
25	64190.004	£ 0	1	Pump valve	64	61002.006	£ 2.5	2	Plug
26	47405.011	£ 1.6	1	Diaphragm	65	41160.003	£ 2.2	3	Idling jet
27	39174.002	£ 0	1	Pump Body	66	52570.005	£ 5.5	3	Jet-holder
28	47600.012	£ 0	1	Spring	67	34894.004	£ 0	3	Choke
29	47407.010	£ 22.2	1	Diaphragm	68	31966.004	£ 0	3	Secondary Venturi
30	32486.009	£ 0	1	Pump Cover - 46 IDA 3C1	69	41530.012	£ 0	3	Gasket
31	32486.010	£ 0	1	Pump Cover - 46 IDA 3C	70	41252.001	£ 7.9	3	Pump jet
32	55525.007	£ 0.7	4	Spring washer	71	64290.005	£ 14.1	3	Delivery valve
33	34705.002	£ 0	4	Nut	72	64290.001	£ 5.7	1	Intake valve
34	64615.006	£ 0	2	Screw	73	61440.213	£ 6.5	3	Emulsifying tube
35	32270.001	£ 0	1	Elastic joint	74	41360.001	£ 1.8	3	Air corrector jet
36	55510.038	£ 0	2	Flat washer	75	41530.022	£ 0	2	Gasket
37	34705.002	£ 0	2	Nut	76	37012.003	£ 0	2	Filter element
38	10006.408	£ 0	1	Spindle oversize	77	64700.007	£ 0	4	Screw

<https://www.carbparts.eu>

Prices and product availability are subject to change

